



Homeowner Kit - Assembly Instructions



Bolton & Lawrence Surrounds



Congratulations on your new surround purchase from Decorative Concepts! Now that the blood is pumping from unpacking the surround, you are ready to put it together. Good luck!

Parts Included in Kit

Included in the homeowner kit is the following:

- One shelf
- Two columns
- Two wraps for bottom of columns
- One mounting board
- One hardware pack

The hardware pack contains the following (extras are included for each item):

- 32- 1 1/4" finish nails
- 5- 1 1/4" screws
- 5- 2" finish screws ("T-10" star drive head)
- 5- 3" screws
- 3- 5" screws
- 1- "T-10" Star drive bit

Tools and Supplies Needed

To assemble the surround, you will need the following:

- A hammer
- A drill with a phillips bit
- 3/16" drill bit
- Wood glue
- A saw to cut the columns (if needed)

Step 1

Determine the desired height of the columns.

COMMENT: The standard height of the columns may suit your needs perfectly, but you may desire to make them shorter. This would depend on several factors: amount of exposed tile wanted around the firebox, amount of room available, personal tastes, etc.

Step 2

Take the shelf and place it upside down on a padded surface.

Step 3

Spread glue on the bottom of the shelf in the area where the columns will be fastened. Place each column on the shelf, aligning them with the vertical edge of the shelf, with the block at the top of the column against the shelf.



NOTE: The homeowner kit can be purchased with two different styles of columns. One style provides a 1/2" gap in the column for tile. The other style of column has no gap for tile. If the columns have a 1/2" gap on one side for tile, place the columns such that the gap in each column is facing towards the inside of the surround. If the columns have no gap, then it does not matter which column is on the right or left of the surround.

Step 4

Using the 1 1/4" screws, attach the columns to the shelf using the pre-drilled holes.



Step 5

Carefully, turn the surround over to an upright position. Place the surround centered over the firebox. Draw a pencil line on the wall along the top edge of the shelf.



Step 6

Remove the surround. Locate the studs in the wall. Place the mounting board 1 1/16" below the pencil line made in step 5 and centered over the firebox. Pre-drill the mounting board for screws using a 3/16" drill bit and attach it to the studs with glue and the 3" screws.



Step 7

Spread glue on the mounting board and replace the surround centered over the firebox. The mounting board fits into the notch in the shelf. Using the 2" finish screws and the pre-drilled holes in the top of the shelf, secure the surround to the mounting board. Use the "T-10" star drive bit provided to secure the 2" finish screws.

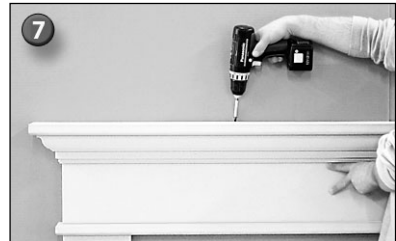

Step 8

Using the 5" screws, secure the bottom of each column to the wall using the pre-drilled holes.

Note: The wraps for the bottom of the columns will cover these screws.

Step 9

Locate the two wraps for the bottom of the columns. Use glue and the 1 1/4" finish nails to attach the wraps to the bottom of the columns.



Step 10

Prep the surround for paint or finish by puttying any visible nail or screw holes. Caulk as needed between the wall and surround. Also, check all the joints in the surround itself and caulk as needed. Sand as needed (which is usually not much). **YOU ARE DONE!**

Note: If painting the surround, it is generally best to prime it prior to painting.

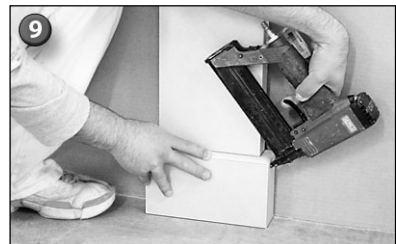

Decorative Concepts

11880 W. President Dr., Suite F | Boise, ID 83713
(208) 323-8033 | (208) 376-5806 fax | info@decorativeconcepts.net